

ORDINANCE NO. 68-37

An Ordinance Amending the "Zoning Ordinance of the City of Portage, Indiana, 1960, Ordinance No. 54."

Section 1. Be it Ordained by the Common Council of the City of Portage, Indiana, under authority of Chapter 174, Acts of the General Assembly, of the State of Indiana, 1947, and all Acts Amendatory thereto:

To re-zone, from R3 to I1, -- A parcel of land in the NE $\frac{1}{4}$ of the NE $\frac{1}{4}$, of Section 8, Township 36 North, Range 6 West, of the Second Principal Meridian, in the City of Portage, Porter County, Indiana, described as : - commencing at a point on the East line of said $\frac{1}{4}$ - $\frac{1}{4}$ section located thereon, 596.16 feet North of the SE corner of said $\frac{1}{4}$ - $\frac{1}{4}$ section; and running thence West parallel with the South line of said $\frac{1}{4}$ - $\frac{1}{4}$ section 1330.5 feet to the West line of said $\frac{1}{4}$ - $\frac{1}{4}$ section a distance of 66.13 feet; thence East parallel with the South line of said $\frac{1}{4}$ - $\frac{1}{4}$ section 1330.5 feet to the East line of said $\frac{1}{4}$ - $\frac{1}{4}$ section; thence South along said East line 66.13 feet to the place of beginning.

General Location: one-half ($\frac{1}{2}$) mile South of U.S. Highway 20 on State Road 149, between U.S. Highway 20 and the B. & O. Railroad Tracks.

Section 2. Effective Date: This Amendment shall become effective immediately upon its enactment and passage by the Common Council of the City of Portage, Indiana.

A Resolution Amending the "Planning Ordinance of the City of

Portage, Indiana, 1960, Ordinance No. 18-87

Section 1. As amended by the Common Council of the City

of Portage, Indiana, under authority of Chapter 171, Acts of the General

Assembly, of the State of Indiana, 1917, and all Acts Amendment thereto:

To read, from 11 to 12, -- A parcel of land in the NW

of the NE 1/4 of Section 8, Township 36 North, Range 3 West,

of the Second Principal Meridian, in the City of Portage,

Portage County, Indiana, described as: -- commencing at a

point on the East line of said 1/4 section located between

and 1/4 mile north of the SE corner of said 1/4 section and

running there West parallel with the South line of said

1/4 section 130.0 feet to the West line of said 1/4 sec-

tion a distance of 66.17 feet; thence East parallel with the

South line of said 1/4 section 130.0 feet to the East line

of said 1/4 section; thence South along said East line

66.17 feet to the point of beginning.

General location: one-half (1/2) mile South of U.S. Highway

59 on State Road 112, between U.S. Highway 59 and the

East of Railroad tracks.

Section 2. Effective Date: This Amendment shall become effective

immediately upon its enactment and passage by the Common Council of the

City of Portage, Indiana.

ORDINANCE NO. 68-37 Con't.

Approved by the Mayor of the City of Portage, this 7th
day of August, 1968.

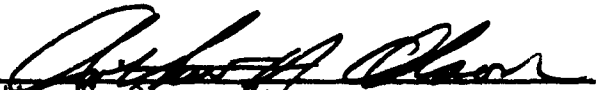
Arthur H. Olson, Mayor
City of Portage, Indiana

I, Edward M. Hagerty, certify that I am
the Executive Secretary of the Plan Commission of the City of Portage,
Indiana; that the preceding is a full, true and correct copy of an
Ordinance accepted by the Plan Commission of the City of Portage,
Indiana, at a regular meeting held the 17th day of July,
1968.

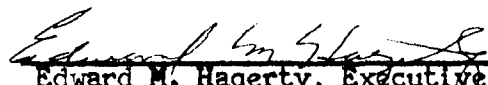
Edward M. Hagerty, Executive Secretary
Portage Plan Commission

This Ordinance prepared by: Michael F. Yudt,
Plan Commission Attorney



REPORT TO COMMON COUNCIL

DATE 7/18/68

CASE # Z-6-68

The Portage Plan Commission met in regular session
at 8:00 p.m., on 17th day of July,
19 68. The Commission voted approval for a favorable recommendation
to re-zone, from R3 to I1, a parcel in the NE $\frac{1}{4}$ of NE $\frac{1}{4}$ of Section 8, Township
36North, Range 6 West; General Location - $\frac{1}{2}$ mile South of U.S. Highway 20
on Highway 149, formerly housing Northwest Electronics.

and thus submit such recommendation to the Common Council of the City of
Portage, Indiana.

Signed this 17th day of July, 19 68.

Edward G. Steyer
Executive Secretary,
Portage Plan Commission



SECRET

CONFIDENTIAL

TOP SECRET

CONFIDENTIAL

CONFIDENTIAL

VEN

CONFIDENTIAL

CONFIDENTIAL

CONFIDENTIAL

CONFIDENTIAL

Case # Z - 6 - 68

Petitioner Arnold & Betty Hatfield

by Attorney Jack Allen

Resolution # R - 6 - 68

PORTAGE PLAN COMMISSION

Whereas, the City of Portage Plan Commission, of the City of Portage, Indiana, has held a public hearing pursuant to notice by publication, as provided by law, concerning an Ordinance # _____, entitled "An Ordinance Amending the Zoning Ordinance, a part of the Master Plan for the City of Portage, Indiana", and,

Whereas, all of the steps prescribed by the Indiana Planning Statute, Chapter 174, of the Acts of the Indiana General Assembly for 1947, and all Acts Amendatory thereto, have been complied with; Now Therefor,

Be it Resolved as follows: that Ordinance # _____ entitled "An Ordinance Amending the Zoning Ordinance, a part of the Master Plan of the City of Portage, Indiana," be approved _____ by said Commission, and that certified copies of this Resolution and said Ordinance, be forwarded to the Common Council of the City of Portage, Indiana, for their action thereon.

This Resolution adopted this 17th day of July, 19 68.

Chairman,
Portage Plan Commission

I, Edward M. Hagerty, certify that I am the Executive Secretary of the City of Portage Plan Commission; that the foregoing is a full, true, and correct copy of a Resolution adopted by the City of Portage Plan Commission at a regular meeting held the _____ day of _____, 19____.

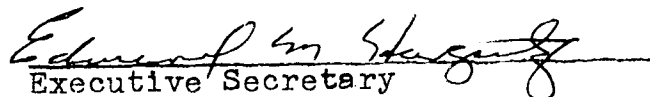
Executive Secretary
Portage Plan Commission



(B)

1332

FLORENCE E & SAMUEL WALSTRA
10 00 A

330.65

33.47

FLORENCE E & SAMUEL WALSTRA
~~DOROTHY ANN OLSON~~
10 00 A

330.65

ARNOLD M & BETTY L HATTIPUD
WES & A

66.14

200'

(RANDALL & LIGHT FOOT
NICK AP...)

595.16

ROAD 19

(I)

1388

PLAT OF SURVEY

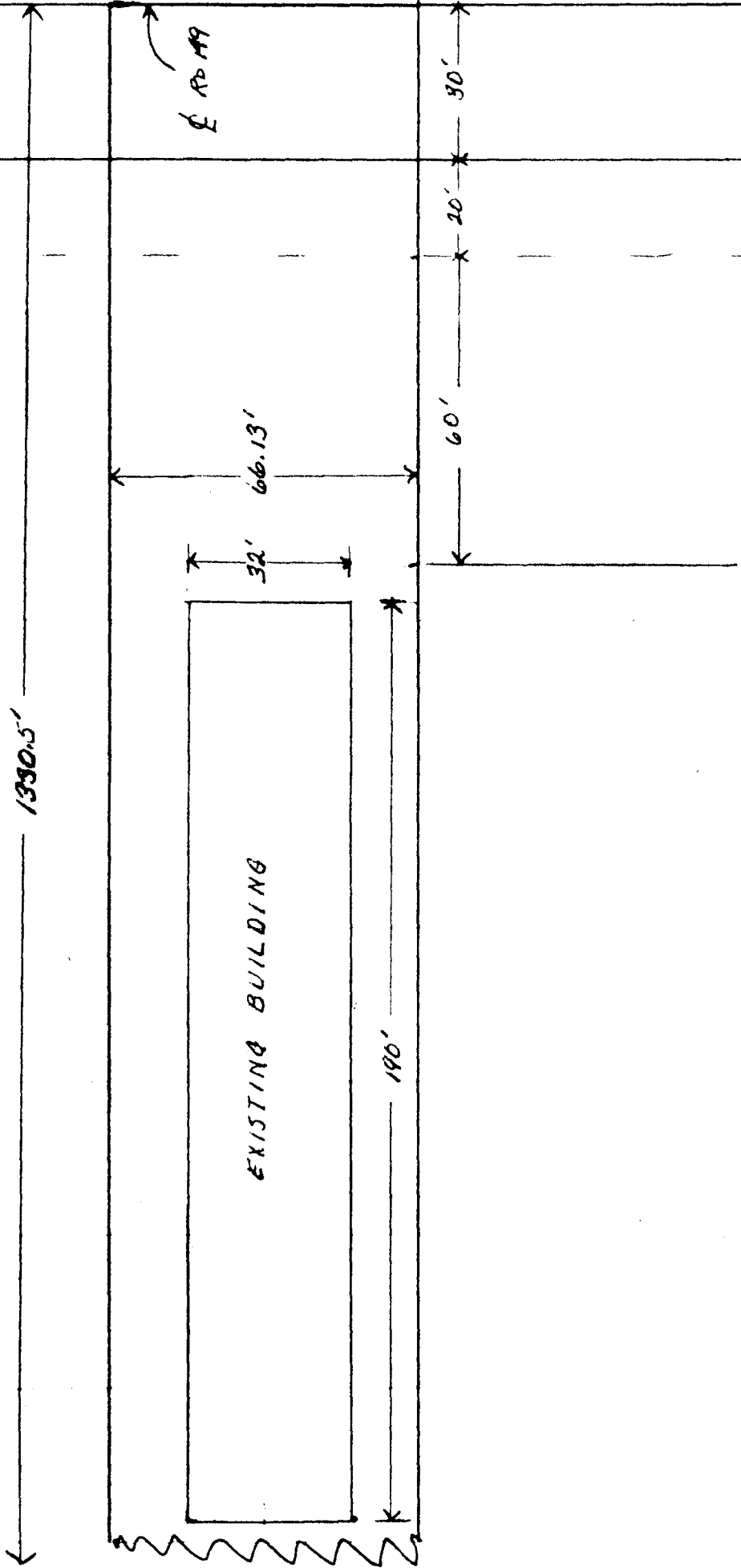

SCALE 1" = 93'